

POWerview VIDEO ENHANCER QUICK GUIDE

Congratulations on purchasing the PowerView Video Enhancer! Designed to improve the output of your video display, the Video Enhancer delivers a sharper image and more vibrant colors, while at the same time reducing eyestrain considerably. The PowerView Video Enhancer is compatible with most systems and can be installed on your PC in minutes!

Your Video Enhancer offers the following benefits:

1. Increased sharpness and brightness
2. Easy to install
3. Hot key toggles *Enhanced* mode on/off
4. No software or driver required.

Connecting the Video Enhancer

As a precaution, before you begin the following procedure, power off your PC and disconnect the power. Locate the VGA port on the rear of your PC and disconnect the signal cable. Then, disconnect the keyboard from the PS/2 port. Refer to Fig. 1 and follow the directions below to connect the Video Enhancer to your PC:

1. Connect the Video Enhancer's VGA connector to the VGA port of your PC. Tighten the securing screws.
2. Connect the monitor's 15-pin mini D-sub plug to the Video Enhancer's VGA port. Again, tighten the securing screws.
3. Connect the Video Enhancer's PS/2 connector to the PS/2 port of your PC.
4. Connect the keyboard to the Video Enhancer's PS/2 port.

Operation

The Video Enhancer requires no software to operate; once you have connected the Video Enhancer to your PC, you are ready to get started. To begin, power on your PC. When the operating system loads, you won't notice any difference in your display output. This is because your monitor is still displaying in original mode. To switch to Enhanced mode press the [Pause] key. The Enhanced mode LED on the Video Enhancer will light.

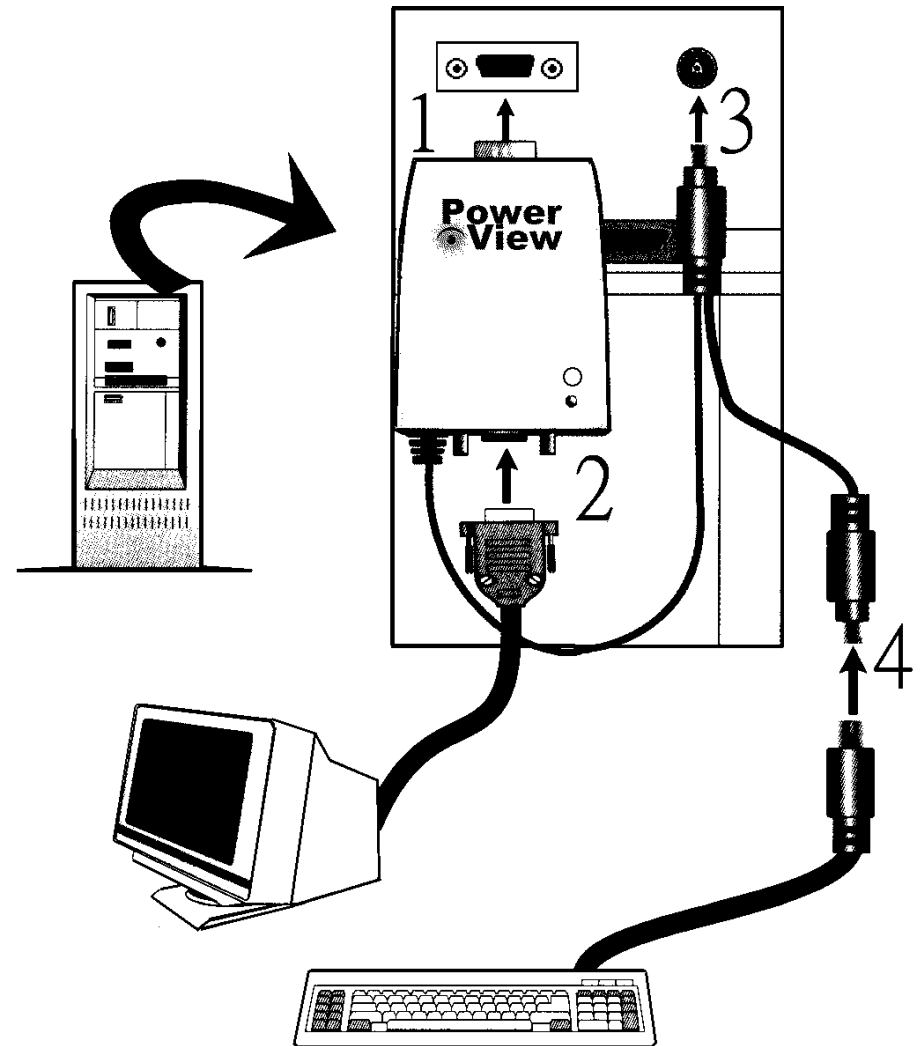

Hit the [PAUSE] key to switch.

-Fig.1-

Getting the Most From Your Video Enhancer

Your monitor can be set to Video Enhancer mode for all media; however, it's when used with graphic-rich media and applications that the benefits are most evident.

In the following table, a check indicates the media recommended for use with the Video Enhancer.

Media	Enhanced Mode	Contrast	Brightness (max.)
CAD	X	100%	50-80%
Digital Camera	√	75-100%	50%
Scanner	√	75-100%	50%
Fax/Modem	X	100%	50-80%
Photo Disk	√	75-100%	50%
Game Disk	√	75-100%	50%
Design Software	√	75-100%	50%
PC/TV	√	90-100%	30-50%
VCD	√	90-100%	50%
CCD	√	90-100%	50%
Video-Phone	√	90-100%	50%
CDI	√	90-100%	50%
MPEG	√	90-100%	50%
Internet Animation	√	80-100%	50%
DVD	√	80-100%	30-50%
3D Game	√	80-100%	30-50%

NOTE: These are recommended settings. 100% means the Contrast or Brightness can be adjusted to its highest level.

Troubleshooting

If the tips in this brief troubleshooting section do not help you to solve your problem, please contact your dealer.

PROBLEM	SOLUTION
The screen is blank.	Make sure that all connectors are securely connected. Confirm that the Status LED is lit. If it is not lit then the Video Enhancer is not receiving power.
Color is off or the image looks unstable.	Make sure the securing screws on the connectors are tightened well.
Color and image look no different than usual.	Enhanced mode may be off. Press the [Pause] hot key to toggle Enhanced mode on.

Specifications

Maximum dpi:	1800x1440 true color
Video bandwidth:	120MHz
Input signal:	0.7p-p/75 ohm, positive pole
Output resistance:	75 ohm
I/O connector:	15-pin mini D-sub plug
Display colors:	Unlimited
Power supply:	DC 12V/100mA
Power consumption:	1.2 Watt. (Maximum)
Control interface:	[Pause] hot key (on keyboard)
Status LED:	Green <i>Enhanced</i> mode
PC compatibility:	All NEC, MAC and IBM monitors
Dimensions:	80x60x20 mm
Recommended Ambience:	Operation: 0~80 °C Storage: -20~60 °C Humidity: 20~90%